



11750 Katy Frwy., Suite 900
Houston, TX 77079
Phone: (866) 564-3835
Website: stabilis-solutions.com

WHO IS STABILIS

Stabilis is headquartered in Houston, TX with a state-of-the-art liquid natural gas production facility in George West, TX and Port Allen, LA as well as a regulated natural gas pipeline in Port Allen. Together with our network of production and distribution partners, we've delivered more than 25,000 deliveries and over 250 million gallons of LNG across the U.S., Mexico, and Canada.

Our customers use LNG and hydrogen in a variety of applications in the industrial, energy, mining, utilities and pipelines, commercial, and high horsepower transportation markets. LNG and hydrogen provide alternatives to traditional fuel sources, resulting in lower fuel costs and reduce harmful environmental emissions. Stabilis' customers also use LNG as a "virtual pipeline" solution when natural gas pipelines are not available, or volumes are curtailed.

WHAT ARE THE SIGNS OF A NATURAL GAS LEAK?

Sight – Liquid pools, discolored vegetation, bubbling in wet areas, dense white cloud or fog, unexplained frozen ground

Sound – An unusual noise like a hissing or roaring sound

Smell: An unusual chemical odor such as rotten eggs if mercaptan is added

WHAT SHOULD I DO IF I SUSPECT A PIPELINE LEAK?

Your personal safety should be your first concern:

- Evacuate the area and prevent anyone from entering
- Abandon any equipment being used near the area
- Avoid any open flames
- Avoid introducing any sources of ignition to the area (such as cell phones, pagers, 2-way radios)
- Do not start/turn off motor vehicles/ electrical equipment
- Call 911 or contact local fire or law enforcement
- Notify the pipeline company
- Do not attempt to extinguish a natural gas fire
- Do not attempt to operate any pipeline valves

PIPELINE SAFETY

System failures occur infrequently along the nation's network of interstate natural gas pipeline facilities, and many of these are caused by damage from others digging near the pipeline. We watch for unauthorized digging, but we request your help to notify us.

ALWAYS CALL 811 BEFORE YOU DIG!

**EMERGENCY CONTACT:
1-225-478-8636**

PRODUCTS/DOT GUIDEBOOK ID#/GUIDE#:		
Natural Gas	1971	115
Natural Gas Liquids	1075	115

**TEXAS
COUNTIES OF OPERATION:**

Live Oak

Changes may occur. Contact the operator to discuss their pipeline systems and areas of operation.



**Know what's below.
Call before you dig.**

EMERGENCY RESPONSE PLANS

An Emergency Response Plan is developed for each pipeline facility to contain, control, and mitigate the various types of emergency conditions/ situations that could occur at one of our facilities. For more information regarding Stabilis emergency response plans and procedures, contact us at 866-564-3835.

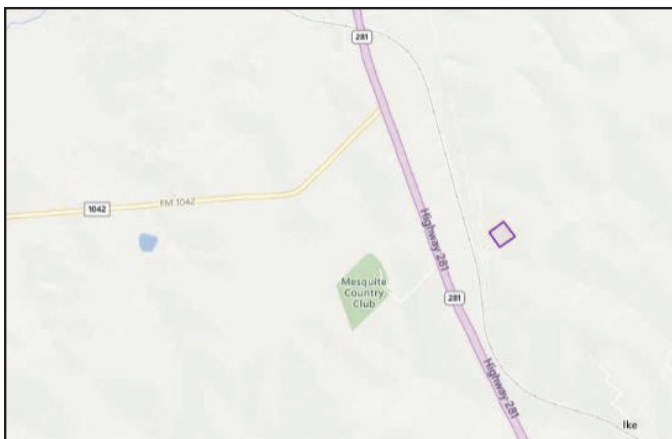

PRODUCT	LEAK TYPE	VAPORS
NATURAL GAS	Gas	Lighter than air and will generally rise and dissipate. May gather in a confined space and travel to a source of ignition.
HEALTH HAZARDS		Will be easily ignited by heat, sparks or flames and will form explosive mixtures with air. Vapors may cause dizziness or asphyxiation without warning and may be toxic if inhaled at high concentrations. Contact with gas or liquefied gas may cause burns, severe injury and/or frostbite.
NATURAL GAS LIQUIDS	Gas	Initially heavier than air, spread along ground and may travel to source of ignition and flash back. Product is colorless, tasteless and odorless.
HEALTH HAZARDS		Will be easily ignited by heat, sparks or flames and will form explosive mixtures with air. Vapors may cause dizziness or asphyxiation without warning and may be toxic if inhaled at high concentrations. Contact with gas or liquefied gas may cause burns, severe injury and/or frostbite. Fire may produce irritating and/or toxic gases.